



Visit the webpage below to see supported devices/download app (scan the QR code for easy access).

www.i-sens.com/smartlog

i-SENS, Inc.

43, Banpo-daero 28-gil, Seocho-gu,
Seoul 06646, Korea
www.i-sens.com



Medical Technology Promedt
Consulting GmbH,
Altenhofstrasse 80, D-66386
St. Ingbert, Germany

Owner's Booklet

CareSens™ Dual

Blood Glucose Monitoring System
Blood β -Ketone Monitoring System

- Easy Data Transfer by Bluetooth Connection
- GDH-FAD Based Test Strips
- Efficient Diabetes Management with Tagging Symbols



Welcome to the CareSens™ Dual Blood Glucose/ Blood β -Ketone Monitoring System

Thank you for choosing the CareSen Dual Blood Glucose/Blood β -Ketone Monitoring System. The system provides you with rapid and convenient blood glucose/blood β -Ketone *in vitro* (i.e., outside the body) diagnostic monitoring. Test results can be sent to a smartphone through Bluetooth® Smart wireless connection.

Bluetooth® Smart wireless technology

Bluetooth Smart wireless technology is used by some smartphones and many other devices. CareSens Dual Meter uses Bluetooth Smart wireless technology to pair* and to send your glucose results to a smartphone.

The CareSens Dual Meter is designed to work with the SmartLog™ mobile app. When using the CareSens Dual System, we suggest you pair your CareSens Dual Meter with your smartphone and track your results.

* The process of creating a connection between two Bluetooth devices. An auto-generated passkey has to be exchanged between the two devices. Once the devices are paired, they will automatically communicate with each other when the Bluetooth feature is activated.

- No part of this document may be reproduced in any form or by any means without the prior written consent of i-SENS.
- The information in this manual is correct at the time of printing. However, i-SENS reserves the right to make any necessary changes at any time without notice as our policy is one of continuous improvement.



WARNING:

Turn off the Bluetooth feature in areas where the use of wireless devices is restricted, such as hospitals, some healthcare professional offices, and aeroplanes.

Trademarks

The Bluetooth® word mark and logos are registered trademarks owned by Bluetooth SIG, Inc. and any use of such marks by i-SENS, Inc. is under license. All other trademarks and trade names are those of their respective owners.

Note:

The SmartLog mobile app may not be compatible with all smartphones.

Table of Contents

Information

Important Information: Read This First!	6
Specifications & Operating Ranges	8
CareSens Dual Blood Glucose/Blood β -Ketone Monitoring System	10
Inserting or Replacing the Batteries	11
Caring for Your System	12
CareSens PRO Blood Glucose Test Strip	13
KetoSens Blood β -Ketone Test Strip	15
CareSens Dual Meter	17
CareSens Dual Meter Display	18

Preparation

Setting Up Your System	19
Setting up Bluetooth	19
Adjusting the Date and Time	23
Setting the Sound On/OFF	25
Turning on the Strip Expiration Date Indicator	26
Setting the Hypoglycemia (Lo) Indicator	27
Setting the Hyperglycemia (HI) Indicator	28
Setting the Strip Expiration Date Indicator	29
Checking the System	30
Control Solution Testing	32
Comparing the Control Solution Test Results	34

Testing

Using the Lancing Device	35
Blood Glucose/Blood β -Ketone Testing	38
Alternative Site Testing (for glucose only)	43
HI and Lo Messages	46
Target Blood Glucose Ranges	47
Transferring Test Results Using Cable	47

Additional Functions

Meter Memory	48
Viewing Averages Stored in Memory	48
Viewing Test Results Stored in Memory	51
Setting the Alarm Function	52
Setting the Post-meal Alarm (PP2 alarm)	52
Setting the Time Alarms (alarm 1-3)	53

Maintenance

Understanding Error Messages	55
General Troubleshooting	57
Performance Characteristics	58
Warranty Information	63

Important Information: Read This First!

For optimum safety and benefits, please read the entire manual contents before using the system.

Intended use:

CareSens Dual Blood Glucose/Blood β -Ketone Monitoring System is used for the quantitative measurement of the glucose/ β -ketone level in capillary whole blood as an aid in monitoring diabetes management effectively at home or in clinical settings. Fresh venous whole blood drawn by healthcare professionals can be used only for testing blood glucose. CareSens Dual Blood Glucose/Blood β -Ketone Monitoring System should be used only for self-testing outside the body (*in vitro* diagnostic use only). CareSens Dual Blood Glucose/Blood β -Ketone Monitoring System should not be used for the diagnosis of diabetes or for the diagnosis of diabetic ketoacidosis. Blood glucose testing sites include the traditional fingertip testing along with alternate sites testing on forearm and palm.

Meaning of Symbols Used:

 For *in vitro* diagnostic use

 This product fulfills the requirements for Directive 98/79/EC on *in vitro* diagnostic medical devices

 Cautions for safety and optimum product use

 Do not discard this product with other household-type waste

 Use by  Authorised representative

 Do not reuse  Batch code

 Consult instructions for use  Manufacturer

 Temperature limitation  Serial number

- Glucose/ β -Ketone in blood samples reacts with the chemical in the test strip to produce a small electrical current. The CareSens Dual meter detects this electrical current and measures the amount of glucose/ β -ketone in the blood sample.
- The CareSens Dual Blood Glucose/Blood β -Ketone Meter is designed to minimise code related errors in monitoring by using the no-coding function.
- The CareSens Dual Blood Glucose/Blood β -Ketone Meter should only be used with CareSens PRO blood glucose and KetoSens β -ketone test strips.
- An abnormally high or low red blood cell count (hematocrit level over 65% or below 15% for blood glucose and hematocrit level over 60% or below 30% for blood β -ketone) may produce inaccurate results.
- If your blood glucose test result is below 3.3 mmol/L or above 13.3 mmol/L, consult a healthcare professional immediately.
- Inaccurate blood glucose results may occur in severely hypotensive individuals or patients in shock. Inaccurate low blood glucose results may occur for individuals experiencing a hyperglycemic- hyperosmolar state, with or without ketosis. Critically ill patients should not be tested with blood glucose/blood β -ketone meters.
- Do not use during or within 24 hours of receiving xylose absorption testing as it may cause inaccurate results.

If you need assistance, please contact your authorised i-SENS sales representative or visit www.i-sens.com for more information.

Specifications & Operating Ranges

Calibration	Plasma-equivalent
Assay method	Electrochemical
Battery life	1,000 tests
Power	Two 3.0 V lithium batteries (disposable, type CR2032)
Memory	1,000 test results
Size	106 x 58 x 17 (mm)
Weight	72.6 g (with batteries)
Bluetooth® Smart technology	<ul style="list-style-type: none"> • Frequency range: 2.4–2.4835 GHz • Operating range distance: maximum 10 metres (unobstructed) • Operating channels: 40 channels • Security encryption: 128-bit AES (Advanced encryption standard)
Relative humidity	10–90%

For blood glucose testing

Measurement range	1.1–33.3 mmol/L
Sample size	Minimum 0.4 µL
Test time	5 seconds
Sample type	<ul style="list-style-type: none"> • Fresh capillary whole blood • Fresh venous whole blood (healthcare professionals only)
Temperature	5–45°C (41–113°F)
Hematocrit	15–65%

For blood β -ketone testing

Measurement range	0.1–8.0 mmol/L
Sample size	Minimum 0.5 µL
Test time	8 seconds
Sample type	Fresh capillary whole blood
Temperature	15–30°C (59–86°F)
Hematocrit	30–60%

CareSens Dual System includes the following items:

- * CareSens Dual Blood Glucose/Blood β -Ketone Meter
- * Owner's Booklet
- * Batteries

Optional items:

- * CareSens PRO Blood Glucose Test Strips
 - * KetoSens Blood β -Ketone Test Strips
 - * Quick Reference Guide
 - * Lancets
 - * Lancing Device
 - * Logbook
 - * Carrying Case
- Check all the components after opening the CareSens Dual Blood Glucose/Blood β -Ketone Monitoring System package. The exact contents are listed on the main box.
 - The cable for data management software can be ordered separately. Please contact your authorised i-SENS sales representative.

The CareSens Dual meter uses two 3.0 V lithium batteries. Before using the meter, check the battery compartment and insert batteries if empty.

When the **+ -** symbol appears on the display while the meter is in use, the batteries should be replaced as soon as possible. The test results may not be saved if the batteries run out.

Step 1

Make sure the meter is turned off. Push the cover in the direction of the arrow to open the battery compartment.

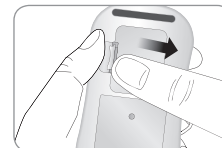

Step 2

Remove the used batteries one at a time. Slip your index finger under the battery to lift and pull out as shown. Insert two new batteries with the + side facing up and make sure the batteries are inserted firmly.



Step 3

Place the cover on the battery compartment. Push it down until you hear the tab click into place.



Note:

Removing the meter batteries will not affect your stored results. However you may need to reset your meter settings. See page 19.

Caring for Your System

Use a soft cloth or tissue to wipe the meter exterior. If necessary, dip the soft cloth or tissue in a small amount of alcohol. Do not use organic solvents such as benzene or acetone, or household and industrial cleaners that may cause irreparable damage to the meter.

Caution:

- Do not expose the meter to direct sunlight, heat, or excessive humidity for an extended period of time.
- Do not let dirt, dust, blood, or water enter into the meter's test strip port.
- Do not drop the meter or submit it to strong shock.
- Do not try to fix or alter the meter in any way.
- Strong electromagnetic radiation may interfere with the proper operation of this device. Keep the device away from sources of strong electromagnetic radiation, especially when measuring your blood glucose/ β -ketone.
- Store all the meter components in the carrying case to prevent loss and help keep the meter clean.

CareSens PRO Blood Glucose Test Strip

The CareSens Dual Blood Glucose Monitoring System measures blood glucose quickly and accurately. It automatically absorbs the small blood sample applied to the narrow edge of the strip.

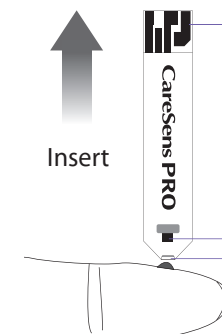

Contact bars

Gently push the test strip, with its contact bars facing up, into the test strip port of meter

Confirmation window

Check here to see whether sufficient blood sample has been applied

Edge to apply blood sample

Apply blood sample here for testing

Warning!

- The CareSens PRO Test Strips should be used with fresh capillary whole blood samples, or with fresh venous whole blood if drawn by healthcare professionals.
- Fresh venous whole blood specimens containing the anticoagulants EDTA and Heparin are acceptable. Iodoacetate or fluoride/oxalate are not recommended.

KetoSens Blood β -Ketone Test Strip

- Do not reuse test strips.
- Do not use test strips past the expiration or discard date.
- Use test strips within twelve (12) months of opening the vial. Record the discard date (the date the vial was opened plus twelve (12) months) on the vial label.
- Store test strips in a cool and dry place at a temperature between 1–30°C (34–86°F).
- Keep test strips away from direct sunlight or heat and do not freeze.
- Store test strips only in their original vial.
- Close the vial tightly after taking out a test strip for testing and use the strip immediately.
- Handle test strips only with clean and dry hands.
- Do not bend, cut, or alter test strips in any way.
- For detailed storage and usage information, refer to the CareSens PRO test strip package insert.

The CareSens Dual Blood β -Ketone Monitoring System measures blood β -ketone quickly and accurately. It automatically absorbs the small blood sample applied to the narrow edge of the strip.

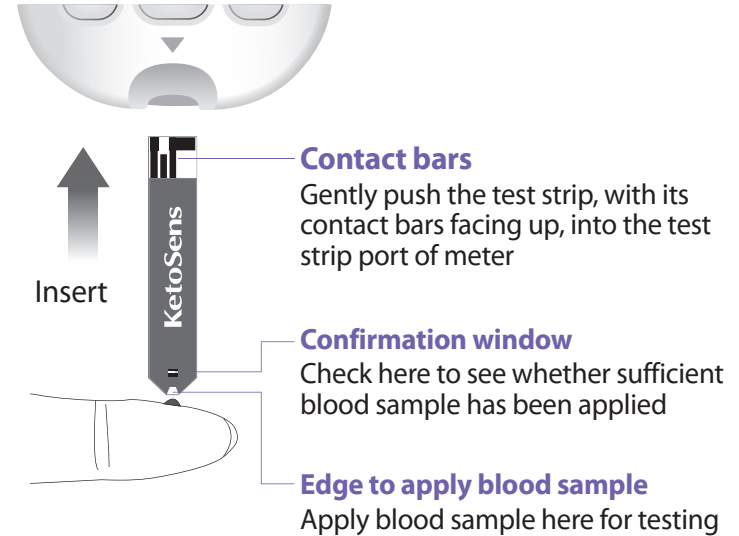

Caution:

- Keep the meter and testing supplies away from young children.
- Drying agents in the vial cap may be harmful if inhaled or swallowed and may cause skin or eye irritation.

CareSens Dual Meter

Warning!

- The KetoSens Blood β -Ketone Test Strips should be used with fresh capillary whole blood samples.
- Do not reuse test strips.
- Do not use test strips past the expiration or discard date.
- Test strips can be used up until the expiration date printed on the foil packet if the test strips are used and stored according to its storage and handling methods.
- Store test strips in a cool and dry place at a temperature of 4–30°C (39–86°F).
- Keep test strips away from direct sunlight or heat and do not freeze.
- Store test strips only in their original box.
- Open the foil test strip packet to take out a test strip for testing and use the test strip immediately. Do not use the test strip if the foil is damaged or torn.
- Handle test strips only with clean and dry hands.
- Do not bend, cut, or alter test strips in any way.
- For detailed storage and usage information, refer to the KetoSens test strip package insert.

Caution:

- Keep the meter and testing supplies away from young children.
- The test strips and foil packet may be choking hazards.

Data Port

Used to transfer data from the meter to a computer with a cable

Display

Shows results, messages

◀▶ Button

Turns the meter on, selects or changes information

S Button

Turns the meter on/off, confirms menu selections, and changes information

Test Strip Port

Insert test strip here



Test Strip Ejector

Slide down to discard the used strips



Note:

- The cable for data management software can be ordered separately. Please contact your authorised i-SENS sales representative.
- The unit of measurement is fixed and it cannot be changed by the user.

CareSens Dual Meter Display

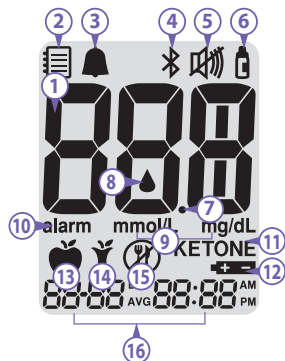

- ① **Test results**
- ② **Memory recall mode** : appears when test results stored in the memory are displayed
- ③ **PP2 alarm** : appears when the post-meal alarm has been set
- ④ **Bluetooth symbol** : appears when Bluetooth® Smart feature is on
- ⑤ **Mute symbol** : appears only when the sound is set to OFF
- ⑥ **Control Solution flag** : indicates that the meter is in Control Solution Test Mode and

appears when the control solution test results are saved or displayed

- ⑦ **Decimal point**
- ⑧ **Blood insertion symbol** : indicates meter is ready for the application of a drop of blood or control solution
- ⑨ **mmol/L, mg/dL** : unit for blood glucose or blood β -ketone
- ⑩ **alarm** : appears when the time alarm has been set
- ⑪ **KETONE** : appears when KetoSens strip is inserted
- ⑫ **Battery symbol** : indicates meter battery is running low and needs to be replaced
- ⑬ **Pre-meal test flag** : used for tests done before eating
- ⑭ **Post-meal test flag** : used for tests done after eating
- ⑮ **Fasting test flag** : used for tests done after fasting for at least 8 hours
- ⑯ **Month/Day/Hour/Minute**

Note:

It is recommended to check if the display screen on the meter matches the illustration above every time the meter turns on. Do not use the meter if the display screen does not exactly match the illustration as the meter may show incorrect results.

Setting Up Your System

Press and hold the **S** for 3 seconds to enter the SET Mode. After all settings are finished, press and hold the **S** button for 3 seconds to turn off the meter. Press **◀**, **▶** to change values. Press and hold **◀**, **▶** to scroll faster.

Step 1 Entering SET Mode

Press and hold the **S** for 3 seconds to enter the SET Mode. After all the segments flash across the screen, the 'SET' will show up. Press the **◀** or **▶** button to select 'YES' and press the **S** button to go to the next step.

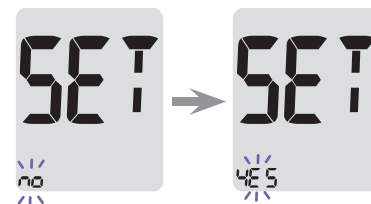

Note:

Follow steps 2–3 to pair your meter and smartphone. Pairing allows the meter to communicate wirelessly with your smartphone. Ensure that devices are within the maximum Bluetooth range (10 metres). Before pairing your meter and smartphone, download and install the SmartLog mobile app on your smartphone.

Setting Up Bluetooth

Step 2 Bluetooth Pairing

① If you do not want to connect your meter to your smartphone, press the **S** button when the screen shows on the right. The meter will go to Step 4 Year Setting Mode.

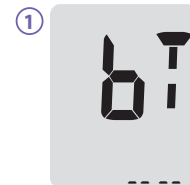

② Press the ◀ or ▶ button. The meter screen shows 'OFF', 'On', and 'PAIR' in turn. To pair your meter with your smartphone, press the **S** button when 'PAIR' blinks on the screen.

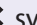
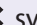

Note:

The  symbol will appear on the screen when the Bluetooth Smart feature is on. When the  symbol is not present on the screen, the Bluetooth Smart feature is off. When you need to turn off/on the Bluetooth Smart feature, press the **S** button when OFF/On blinks on the screen.

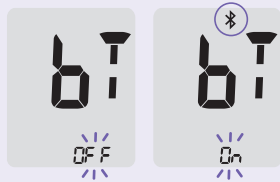

Step 3 Entering the PIN number

① The  symbol and 'PIN' will appear if you press the **S** button when the meter screen shows 'PAIR'.

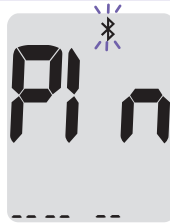

② On your smartphone, launch the SmartLog mobile app and select 'more' at the bottom of the screen. Select 'Meter Connection' → 'Bluetooth' → 'Search'.



③ Look for 'CareSens' and the last 4 characters of the meter serial number on the SmartLog mobile app screen to correctly identify your meter. Touch your meter's ID (CareSens XXXX) on the SmartLog mobile app screen.

Serial number



④ The meter will display six digit PIN number.



⑤ Enter the PIN number into the SmartLog mobile app and touch 'OK'. Make sure the PIN you enter on your smartphone matches the PIN on your meter screen.



⑥ When your meter and smartphone are paired and connected, the meter will display 'SUCCESS' and the saved test results will be transferred to your smartphone.



⑦ When the data transfer is finished, the meter will display 'End' on the screen. Press the **S** button to go to Step 10 Sound Setting mode. See page 25. If the meter displays 'FAIL' and then 'OFF', repeat steps 2 to 5.



Note:

Some smartphones, especially those that are not tested or approved by i-SENS, may be incompatible with your meter. Visit www.i-sens.com/smartlog for more information about supported smartphones. You can also scan the QR code on the back cover of this user manual.

Adjusting the Date and Time

Step 4 Setting the Year

Press the ◀ or ▶ button to adjust until the correct year appears. When the present year appears, press the **S** button to confirm your selection and to go to the next step.



Step 5 Setting the Month

A number indicating the month will blink on the screen. Press the ◀ or ▶ button until the correct month appears. Press the **S** button to confirm your selection and to go to the next step.



Step 6 Setting the Date

Press the ◀ or ▶ button until the screen displays the correct date. Press the **S** button to confirm the date and to go to the next step.



Step 7 Setting the Time Format

The meter can be set in the AM/PM 12-hour or the 24-hour clock format. Press the ◀ or ▶ button to select a format. The AM•PM symbol is not displayed in the 24-hour format. After selecting the format, press the **S** button to go to the next step.



Step 8 Setting the Hour

Press the ◀ or ▶ button until the correct hour appears. After the hour is set, press the **S** button to go to the next step.



Step 9 Setting the Minute

Press the ◀ or ▶ button until the correct minute appears. After setting the minute, press the **S** button to go to the next step.



Setting the Sound On/OFF

Step 10

On pressing the ◀ or ▶ button, the screen will display On or OFF. Press the **S** button to confirm the selection.



The meter will beep in the following instances if set to On.

- When you push a button to turn on the meter
- When the test strip is inserted in the meter
- When the blood sample is absorbed into the test strip and the test starts
- When the test result is displayed
- When you press and hold the ◀ button to set the post-meal (PP2) alarm
- When it is time for a pre-set blood glucose test



If the sound is set to OFF, none of the sound functions will work. After setting the sound, press the **S** button to progress to the next step.

Note:

The  symbol is displayed only when the sound is set to OFF.

Turning on the Strip Expiration Date Indicator

Step 11

This mode allows you to turn the strip expiration date indicator on or off. This mode turns the function on or off only. See page 29 to set the strip expiration date.

When 'EP' appears on the screen, press the ◀ or ▶ button. The screen will display 'On' or 'OFF'. Press the **S** button to confirm the setting.

If you do not want to set the indicator, press the **S** button while the screen displays 'OFF'.



Note:

If the pre-set expiration date expires, the meter will display EP when the test strip is inserted. EP shows alternately also when the test result is displayed right after the test. If the expiration date is set to October of 2019, the meter will display EP at the start of November, 2019.

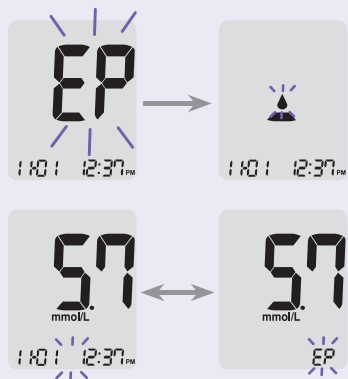

Setting the Hypoglycemia (Lo) Indicator

Step 12

This mode allows you to turn the hypoglycemia indicator (possible low blood sugar) On or OFF and to select the desired level for the indicator. You will be alerted any time your test result is lower than the selected level. On pressing the ◀ or ▶ button, the screen will display 'On' or 'OFF'. Press the **S** button when 'On' appears to enter the setting. Press the ◀ or ▶ button until the desired hypoglycemia level between 1.1 and 5.0 mmol/L appears. Press the **S** button to confirm the hypoglycemia level and to go to the next step.

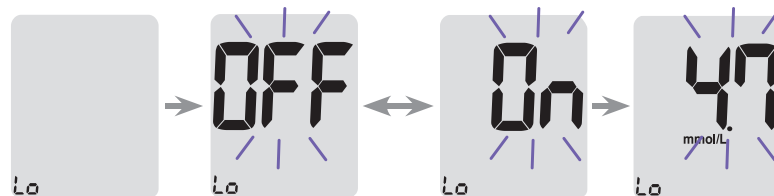

Note:

If the test result is lower than the pre-set hypoglycemia level, the meter will display the following.

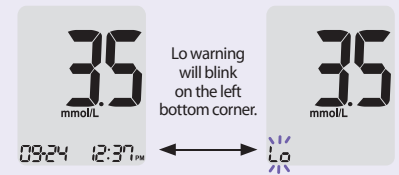

Caution:

Ask your healthcare professional to help you decide what your hypoglycemia level is before setting your level.

Setting the Strip Expiration Date Indicator

Setting the Hyperglycemia (HI) Indicator

Step 13

This mode allows you to turn the hyperglycemia indicator (possible high blood sugar) On or OFF and to select the desired level for the indicator. You will be alerted any time your test result is higher than the selected level. On pressing the ◀ or ▶ button, the screen will display 'On' or 'OFF'. Press the **S** button when 'On' appears to enter the setting. Press the ◀ or ▶ button until the desired hyperglycemia level between 6.7 and 19.4 mmol/L appears. Press and hold the **S** button to confirm the hyperglycemia level and turn the meter off.

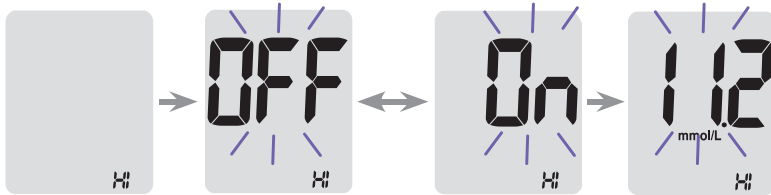

Note:

If the test result is higher than the pre-set hyperglycemia level, the meter will display HI on the bottom. KETONE symbol blinks 3 times when the result is higher than 13.3 mmol/L.



Caution:

Ask your healthcare professional to help you decide what your hyperglycemia level is before setting your level.

Step 1 Entering the Expiration Date Setting

Press and hold the ◀ and ▶ buttons at the same time for 3 seconds to enter the expiration date settings. After all segments flash across the screen, 'EP' will show up.

Note:

- The strip expiration date indicator functions only when CareSens PRO test strip is inserted.
- The strip expiration date is printed on the CareSens PRO test strip vial.

Step 2 Setting the Year

A number indicating the year will blink in the left corner of the screen. Press the ◀ or ▶ button until the correct year appears. Press the **S** button to confirm the year and set the month.



Step 3 Setting the Month

A number indicating the month will blink at the bottom of the screen. Press the ◀ or ▶ button until the correct month appears. Press and hold the **S** button for 3 seconds to confirm the month and turn off the meter.



Checking the System

CareSens PRO Control Solution with CareSens PRO Test Strips



You may check your meter and CareSens PRO test strips using the CareSens PRO Control Solution (control L and/or H).

The CareSens PRO Control Solution contains a known amount of glucose and is used to check that the meter and the test strips are working properly. The CareSens PRO test strip vials have CareSens PRO Control Solution ranges printed on their labels. Compare the result displayed on the meter to the control solution range printed on the test strip vial. Before using a new meter or a new vial of test strips, you may conduct a control solution test following the procedure on pages 32–33.

KetoSens Control Solution with KetoSens Test Strips



You may check your meter and KetoSens test strips using the KetoSens Control Solutions (control L/M/H).

The KetoSens Control Solution contains a known amount of glucose β -ketone and is used to check that the meter and the test strips are working properly.

KetoSens Control Solution ranges are printed on the KetoSens test strip box. Compare the result displayed on the meter to the KetoSens Control Solution range printed on the test strip box. Before using a new meter or a new box of test strips, you may conduct a control solution test following the procedure on pages 32–33.

Notes:

- Use the CareSens PRO Control Solutions and KetoSens Control Solutions only with their corresponding test strips. The control solutions are available for purchase separately.
- Check the expiration date printed on the bottle.
- Make sure your meter, test strips, and control solution are at room temperature before testing. Control solution tests must be done at room temperature (20–25°C/68–77°F).
- Before using the control solution, shake the bottle, discard the first few drops and wipe the tip clean.
- Close the control solution bottle tightly and store at a temperature between 8–30°C (46–86°F).

You may do a control solution test:

- When you want to practice the test procedure using the control solution instead of blood
- When using the meter for the first time
- Whenever you open a new vial or a new box of test strips
- If the meter or test strips do not function properly
- If your symptoms are inconsistent with the blood glucose test results and you feel that the meter or test strips are not working properly
- If you drop or damage the meter

Control Solution Testing

Step 1 Inserting Test Strip



Insert a test strip into the meter's test strip port, with the contact bars facing upwards.

Gently push the test strip into the port until the meter beeps. Be careful not to bend the strip while pushing it in.

The  symbol will show up. 'KETONE' will be displayed on the screen if you insert the KetoSens test strip.



Step 2 Activating Control Solution Test Mode

Press and hold the  button for 3 seconds to activate the Control Solution Test Mode. This will also flag the control solution test result. To undo the control solution flag, press and hold the  button for another 3 seconds.

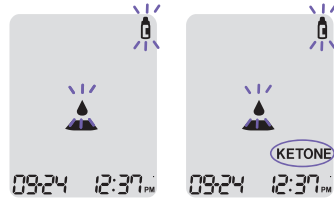



Step 3 Applying Control Solution to Test Strip

Shake the bottle before each test.

Remove the cap and squeeze the bottle to discard the first drop. Then wipe the tip with a clean tissue or cloth.

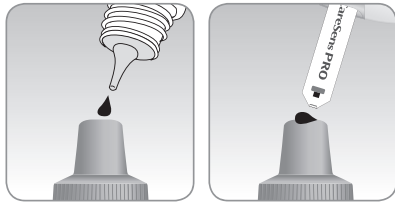
Dispense a drop of control solution onto a clean non-absorbent surface. It helps to squeeze a drop onto the top of the cap as shown. After the  symbol appears on the display, apply the solution to the narrow edge of the test strip until the meter beeps. Make sure the confirmation window fills completely.



Note: The meter may switch off if the control solution sample is not applied within 2 minutes of the  symbol appearing on the screen. If the meter turns off, remove the strip, reinsert, and start from step 1.

Step 4 Waiting for the Result

The display segments will rotate clockwise and a test result will appear after the meter counts down from 5 to 1 if you test with CareSens PRO test strip and CareSens PRO control solution.

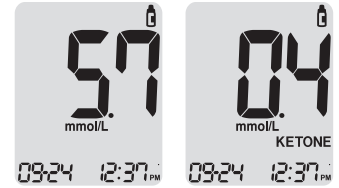

In case of KetoSens test strip and KetoSens control solution, the test result will appear after the meter counts down from 8 to 1.

The test result with control solution flag is stored in the memory but not included in the averages.

Step 5 Comparing the Result

Compare the result displayed on the meter to the range printed on the test strip vial or box. The result should fall within the range.

Control Solution Range
Control L: 5.6–8.4 mmol/L
Control H: 10.2–15.3 mmol/L

Control Solution Range
Control L : 0.4–1.0 mmol/L
Control M: 1.9–2.9 mmol/L
Control H : 3.4–5.4 mmol/L

Caution: The range printed on the test strip vial or box is for the Control Solution only. It has nothing to do with your blood glucose or your blood β -ketone levels.

Using the Lancing Device

Comparing the Control Solution Test Results

The test result of each control solution should be within the range printed on the label of the test strip vial or on the test strip box. Repeat the control solution test if the test result falls outside of the range. Out of range results may occur in following situations:

Situations	Do This
<ul style="list-style-type: none"> • When the control solutions are not used with their corresponding test strips, • When the control solution bottle was not shaken well, • When the meter, test strip, or the control solution were exposed to high or low temperatures, • When the first drop of the control solution was not discarded or the tip of the bottle was not wiped clean, • When the meter is not functioning properly. 	Repeat the control solution test by referring to the notes on page 31.
<ul style="list-style-type: none"> • When the control solution is past the expiration date printed on the bottle, • When the control solution is past its discard date, • When the control solution is contaminated. 	Discard the used control solution and repeat the test using a new bottle of control solution.

If results continue to fall outside the range, the test strip and meter may not be working properly. Do not use your system and contact i-SENS sales representative.

You will need a lancing device in order to collect a blood sample.

You may use the lancing device that is included in the CareSens Dual System or any other medically approved lancing device.

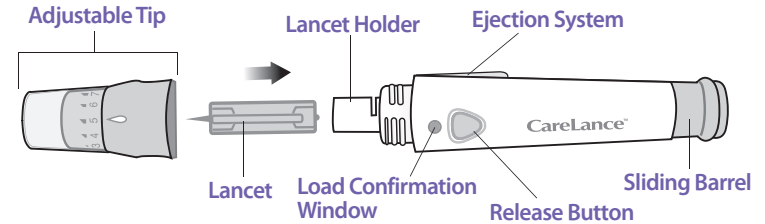

- The lancing device is for use by a single user only and should not be shared with anyone.
- Use a soft cloth or tissue to wipe the lancing device. If necessary, a small amount of alcohol on a soft cloth or tissue may be used.

Caution:

To avoid infection when drawing a sample, do not use a lancet more than once, and:

- Do not use a lancet that has been used by others.
- Always use a new sterile lancet.
- Keep the lancing device clean.

Note:

Repeated puncturing at the same sample site may cause pain or skin calluses (thick hard skin). Choose a different site each time you test.

Preparing the Lancing Device

Step 1

Wash hands and sample site with soap and warm water. Rinse and dry thoroughly.

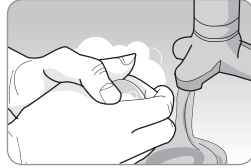

Step 2

Unscrew and remove the lancing device tip.

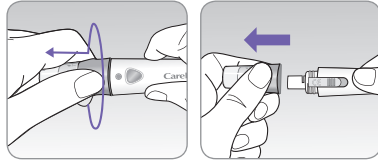

Step 3

Firmly insert a new lancet into the lancet holder. Hold the lancet firmly. Gently twist to pull off protective disk. Save disk to recap lancet after use. Replace lancing device tip.

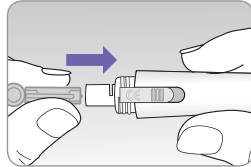

Step 4

Turn the adjustable tip until it is aligned with the load confirmation window and release button as shown.

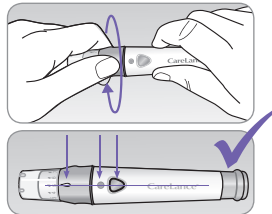

Step 5

The lancing device has seven puncture depth settings, numbered 1 through 7 (1 for a shallow puncture, 7 for a deeper puncture).

Choose a depth by rotating the top portion of the adjustable tip until the desired number aligns with the arrow.

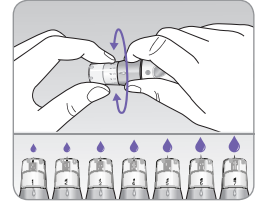

Note:

- 1 = least penetration of lancet into the skin.
- 7 = most penetration of lancet into the skin.

Step 6

To cock the lancing device, hold the body of lancing device in one hand and pull the sliding barrel with the other hand. The device is loaded when you feel a click and the load confirmation window turns red.

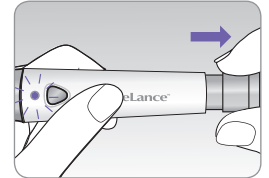

Note:

The skin depth to get blood samples will vary for various people at different sample sites. The lancing device's adjustable tip allows the best depth of skin penetration to get an adequate sample size.

Blood Glucose/Blood β -Ketone Testing

Check your ketone:

- When you have an illness,
- When your blood glucose is above 13.3 mmol/L,
- When you and your healthcare professional feel it is necessary.

Preparing the Meter and Test Strip

Step 7

Insert a test strip with the contact bars facing upwards into the meter's test strip port. Push the strip in gently until the meter beeps. Be careful not to bend the test strip. The  symbol will appear on the screen. When you insert KetoSens test strip, the meter shows 'KETONE' on the screen.

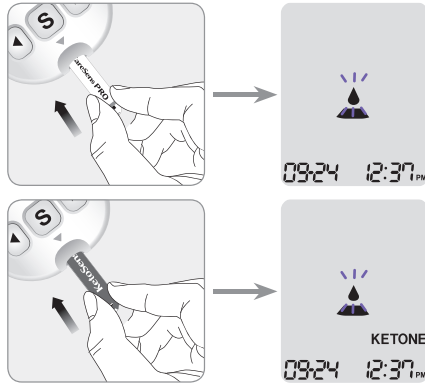

Applying Blood Sample

Step 8

Obtain a blood sample using the lancing device. Place the device against the pad of the finger. The best puncture sites are on the middle or ring fingers. Press the release button.

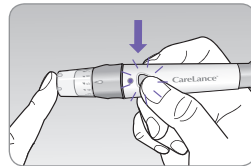

Remove the device from the finger. Wait a few seconds for a blood drop to form. You need a minimum volume of 0.4 microliter for blood glucose test with CareSens PRO test strip and 0.5 microliter for blood β -ketone test with KetoSens test strip. (Actual size of 0.5 μ L: )

Step 9

After the  symbol appears on the screen, apply the blood sample to the narrow end of the test strip till the meter beeps. If the confirmation window is not filled in time because of abnormal viscosity (thickness and stickiness) or insufficient volume, the Er4 message may appear.

It is recommended to place the test strip vertically into the blood sample site as shown below.

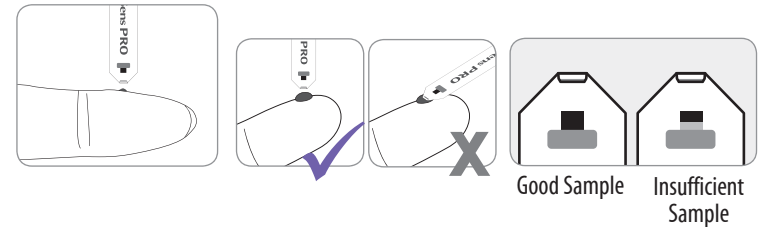

Note:

The meter may switch off if the blood sample is not applied within 2 minutes of the  symbol appearing on the screen. If the meter turns off, remove the strip and reinsert it, and start from Step 2.

Step 10

At this time, the display segments will rotate clockwise while the blood is going in.

Blood glucose test results will appear after the meter counts down from 5 to 1, and blood β -ketone test results from 8 to 1. The result will be automatically stored in the meter's memory. If the test strip is removed after the test result is displayed, the meter will automatically switch off after 3 seconds. Discard used test strips safely in disposable containers. If the Bluetooth feature is activated, the meter will send the test result to the connected smartphone.

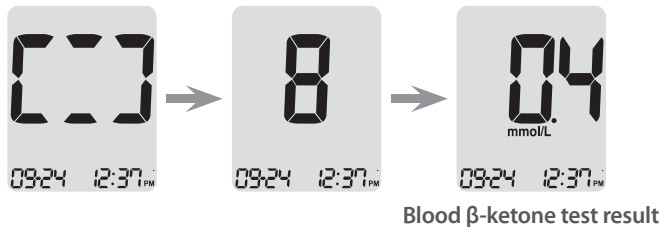
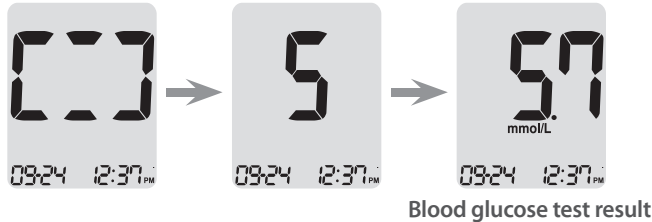

Note:

To transmit glucose data using the Bluetooth feature,

- The Bluetooth feature on the meter must be turned on,
 - The meter and a smartphone must be paired,
 - The SmartLog mobile app must be launched.
- The meter will transmit data in the following cases,
- When the strip is ejected after measuring,
 - When the meter is turned on (only when untransmitted data exists).



Step 11

You can attach a flag to a blood glucose test result to indicate particular situations while the strip is still in the meter. When the result is displayed right after a test, press \blacktriangleleft or \blacktriangleright button to select a pre-meal flag (🍏), a post-meal flag (🍷), or a fasting flag (🕒). When you remove the test strip while the desired flag is blinking, the test result is stored with the flag. If you do not want to add any flags on the test result, remove the strip after the test result is displayed.

When you test your blood β -ketone, there is no need to attach any flag.

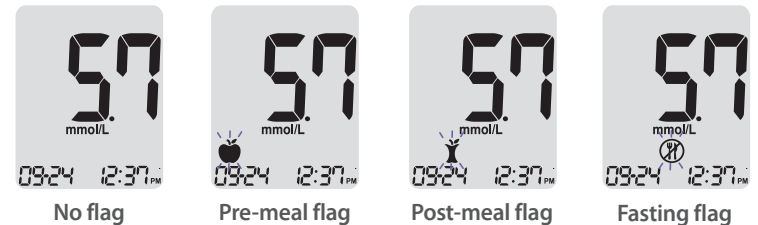

Alternative Site Testing (for glucose only)

Discarding Used Lancets

Step 1

Unscrew the lancing device tip.

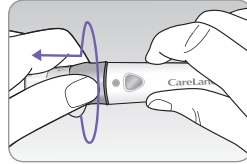

Step 2

Stick the lancet into the saved protective disk.
Push the lancet ejector forward with the thumb to dispose of the used lancet in a proper biohazard container.

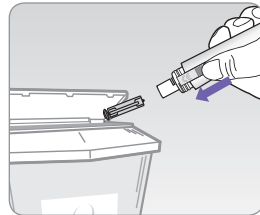
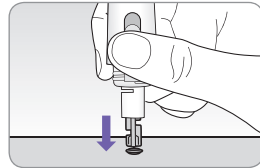

Caution:

The lancet is for single use only. Never share or reuse a lancet. Always dispose of lancets properly.

Before using AST, please consult your healthcare professional.

What is AST (Alternative Site Testing)?

Usually, we take the blood sample from the tip of the finger. However, since there are many nerve endings in the fingertip, it can be quite painful. When doing a glucose test, using different parts of the body such as the forearms and palms can reduce the pain during testing. This method of testing with different parts of the body is called Alternative Site Testing. While AST may reduce the pain during testing, it may not be simple for everyone and **you should not use AST for your blood β -ketone test**. The following precautions should be observed during testing.

Alternative Sites for Testing



Alternative Site Blood Sampling (forearm and palm)

Select a clean, soft and fleshy sample site area free of visible veins and hair and away from bones. Gently massage the sample site to help blood circulation to minimise result differences between fingertip and alternative site sampling. Firmly press and hold the lancing device against site. Wait until the skin surface under the lancing device changes color. Then press the release button while continuing to apply pressure. Keep holding the lancing device against your skin until sufficient (at least 0.4 μ L, actual size: ●) blood is drawn. Carefully lift the lancing device away from your skin.

Things to Know When Using AST

Please read the following before testing at alternative sites (forearms and palms).

The capillary whole blood of the fingertips reflects changes in glucose levels more rapidly than in alternative sites. The test results from the fingertip testing and AST may differ due to factors such as lifestyle and ingested food which affect glucose levels.

Acceptable Situations for AST

When your blood glucose levels are stable

- Fasting period
- Before a meal
- Before going to bed

Situations Requiring Fingertip Test

When your blood glucose levels are unstable

- During two (2) hours after a meal or exercise
- When sick or when glucose levels seem quite lower than test value
- When hypoglycemia is not well recognised
- When insulin has the biggest effect
- During two (2) hours after an insulin injection

AST Precautions

- Before using AST, please consult your healthcare professional.
- Do not use AST for your blood β -ketone test.
- Do not ignore the symptoms of hyperglycemia or hypoglycemia.
- When the results of the test do not reflect your opinion, retest using the fingertip test. If the fingertip result still does not reflect the way you feel, please consult your healthcare professional.
- Do not rely on the AST results for changing your treatment method.
- The amount of glucose in alternative sites differs from person to person.

Note:

- Results from alternative sites and fingertip samples may differ from each other as there is a time lag for the glucose levels to reach the same value. Use a fingertip for testing if you suffer from hypoglycemia or have experienced hypoglycemic shock or symptoms.
- If the sample drop of blood runs or spreads due to contact with hair or with a line in your palm, do not use that sample. Try puncturing again in a smoother area.

HI and Lo Messages

HI Message

The meter displays blood glucose results between 1.1–33.3 mmol/L. 'HI' appears when the blood glucose level is greater than 33.3 mmol/L and indicates severe hyperglycemia (much higher than normal glucose levels).

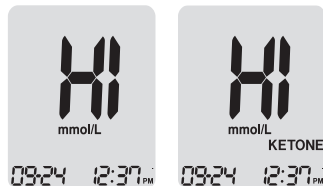

The meter displays blood β -ketone results between 0.1–8.0 mmol/L. 'HI' appears when the blood β -ketone level is greater than 8.0 mmol/L.

If 'HI' is displayed again upon retesting, please contact your healthcare professional immediately.

Lo Message

'Lo' appears when a blood glucose test result is less than 1.1 mmol/L and indicates severe hypoglycemia (very low glucose levels). If 'Lo' is displayed again upon retesting, please contact your healthcare professional immediately.

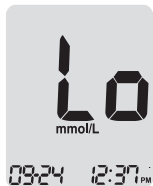

Note:

- In case of blood β -ketone test, 0.0 mmol/L appears when a test result is less than 0.1 mmol/L.
- Please contact your authorised i-SENS sales representative if such messages are displayed even though you do not have hyperglycemia or hypoglycemia.

Target Blood Glucose Ranges

Reminders

Your target ranges
from your healthcare professional

Time of day

Before breakfast

Before lunch or dinner

1 hour after meals

2 hours after meals

Between 2 a.m. and 4 a.m.

Expected Values : The range of a normal fasting* blood glucose level for non-diabetic adults is between 3.9–5.5 mmol/L. Two (2) hours after a meal, the range of a normal blood glucose level for non-diabetic adults is less than 7.8 mmol/L.

*Fasting is defined as no caloric intake for at least eight (8) hours.

Reference

American Diabetes Association. "Standards of Medical Care in Diabetes -2016." *Diabetes Care*. January 2016; 39(1):S15, S100.

Transferring Test Results Using Cable

Test results stored in CareSens Dual meter can be transferred from the meter to a computer using SmartLog software and cable. The meter screen displays 'Pc' when it is connected to the computer using the data cable. For more information, contact your authorised i-SENS sales representative or visit www.i-sens.com.



Note: Test results can also be transferred wirelessly using Bluetooth. To pair the meter and your smartphone, see page 19.

Meter Memory

The CareSens Dual meter can save up to 1,000 test results with time and date. If the memory is full, the oldest test result will be deleted and the latest test result will be stored.

The meter only calculates and displays the averages of blood glucose test results by total test results, Pre-meal (🍏) test results, Post-meal test (🍷), and Fasting test results (🚫) from the last 1, 7, 14, 30 and 90 days.

Viewing Averages Stored in Memory

Step 1

Press any button to turn the meter on. The current date and time will be displayed at the bottom of the screen followed by the 1 day average value and the number of the test results saved within the current day.



The number of tests within the current day

Step 2 Viewing Averages

Press the ◀ button to view 1, 7, 14, 30 and 90-day average values and the number of tests performed for the last test period.

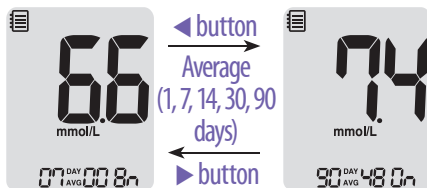

Step 3 Viewing Pre-meal Averages

Repeatedly press the ◀ button to view 1, 7, 14, 30 and 90-day average values and the number of tests performed pre-meals with the 🍏 symbol for the last test period.

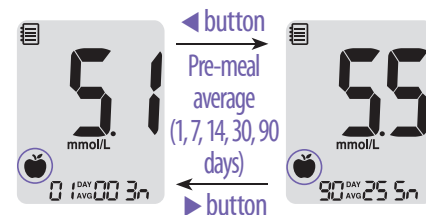

Step 4 Viewing Post-meal Averages

Press the ◀ button to view 1, 7, 14, 30 and 90-day average values and the number of tests performed post-meals with the 🍷 symbol for the last test period.

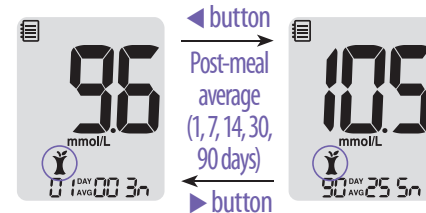

Step 5 Viewing Fasting Averages

Press the ◀ button to view 1, 7, 14, 30 and 90-day average values and the number of tests performed during fasting with the 🚫 symbol for the last test period.

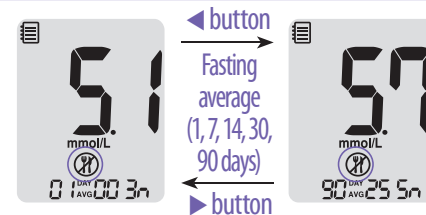

Step 6

Use the ► button to scroll back through the averages seen previously.
Press the **S** button to turn off the meter.

Note:

The control solution test results saved with the  symbol are not included in the averages.

Viewing Test Results Stored in Memory

Step 1

Press any button to turn the meter on. The current date and time will be displayed at the bottom of the screen followed by the 1 day average value and the number of the test results saved within the current day.



The number of tests within the current day

Step 2

Use the ► button to scroll through the test results, starting from the most recent and ending with the oldest.

Press the ◀ button to return to the results seen previously.

After checking the stored test results, press the **S** button to turn off the meter.

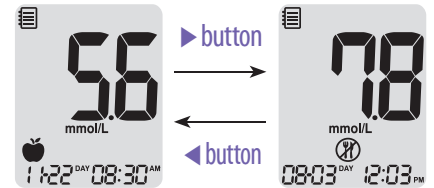

Setting the Alarm Function

Four types of alarms can be set in the CareSens Dual Meter: one post-meal alarm (PP2 alarm) and three time set alarms (alarm1–3). The PP2 alarm goes off 2 hours after setting the alarm. The alarms ring for 15 seconds and can be silenced by pressing any button or by inserting a test strip.

Setting the Post-meal Alarm (PP2 alarm)

Step 1 Turning the PP2 alarm On

Without inserting a test strip, press and hold the ◀ button for 3 seconds to set the post-meal alarm.

'PP2', bell (🔔) symbol and 'On' will be displayed. The screen will then automatically change to the memory recall mode. At this time, bell (🔔) symbol, indicating that the PP2 alarm has been set, will be displayed on the screen.

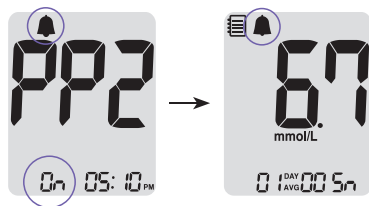

Note:

The PP2 alarm will automatically turn off if the meter's time setting is adjusted to more than two hours before or just past the currently activated PP2 alarm time.

Step 2 Turning the PP2 alarm OFF

To turn off the PP2 alarm, press and hold the ◀ button for 3 seconds. 'PP2', bell (🔔) symbol and 'OFF' will appear on the screen. Then the screen will change automatically to the memory recall mode without bell (🔔) symbol displayed.

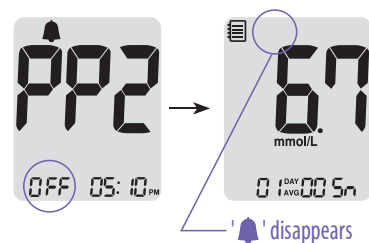

Setting the Time Alarms (alarm 1–3)

Step 1

Without inserting a test strip, press the ◀ and S buttons simultaneously for 3 seconds to enter the time alarm mode. 'alarm1' will be displayed while 'OFF' blinks on the screen.



Step 2

On pressing the ▶ button, 'alarm1' is set and 'On' is displayed on the screen. Press the ▶ button again to cancel 'alarm1'. 'OFF' will blink on the screen.

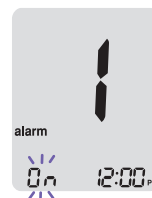

Step 3

Press the ◀ button while 'On' blinks to adjust the time of 'alarm1'. A number indicating the hour will blink on the screen. Press the ▶ button to set the hour.

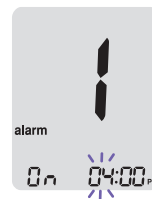

Understanding Error Messages

Step 4

On pressing the ◀ button, the number indicating the minute will start blinking. Press the ▶ button to set the minute.







Step 5

Press the **S** button to finish and to go to 'alarm2' mode. Repeat steps 2 to 4 to set the remaining time alarms (alarm2–3).







Step 6

Press the **S** button for 3 seconds to finish and turn the meter off.

	<p>A used test strip was inserted. > Repeat the test with a new test strip.</p>
	<p>The blood or control solution sample was applied before the ▲ symbol appeared. > Repeat the test with a new test strip and wait until the ▲ symbol appears before applying the blood or control solution sample.</p>
	<p>The temperature during the test was above or below the operating range. > Move to an area where the temperature is within the operating range for blood glucose test (5–45°C) or the operating range for blood β-ketone test (15–30°C) and repeat the test after the meter and test strips have reached a temperature within the operating range.</p>
	<p>The blood sample has abnormally high viscosity or insufficient volume. > Repeat the test with a new test strip.</p>

General Troubleshooting

	<p>This error message may appear when the wrong blood glucose test strip is used instead of CareSens PRO or KetoSens test strip.</p> <p>> Repeat the test with a CareSens PRO or KetoSens test strip.</p>
	<p>There is a problem with the meter.</p> <p>> Do not use the meter. Contact your authorised i-SENS sales representative.</p>
	<p>There is a problem with Bluetooth communication.</p> <p>> Contact your authorised i-SENS sales representative.</p>
	<p>An electronic error occurred during the test.</p> <p>> Repeat the test with a new test strip. If the error message persists, contact your authorised i-SENS sales representative.</p>

Note:

If the error messages persist, contact your authorised i-SENS sales representative.

Problem	Troubleshooting
<p>The display is blank even after inserting a test strip.</p>	<ul style="list-style-type: none"> • Check whether the test strip is inserted with the contact bars facing up. Check if the strip has been inserted completely into the test strip port. • Check if the appropriate test strip was used. • Check whether the batteries are inserted with the + side facing up. • Replace the batteries.
<p>The test does not start even after applying the blood sample on the strip.</p>	<ul style="list-style-type: none"> • Check if the confirmation window is filled completely. • Repeat the test after inserting a new test strip.
<p>The test result does not match the way you feel.</p>	<ul style="list-style-type: none"> • Repeat the test after inserting a new test strip. • Check the expiration or discard date of the test strip. • Perform control solution test.

Note:

If the problem is not resolved, please contact your authorised i-SENS sales representative.

Performance Characteristics

The performance of CareSens Dual Blood Glucose/Blood β -Ketone Monitoring System has been evaluated in laboratory and in clinical tests.

Glucose

Accuracy: The accuracy of the CareSens Dual Blood Glucose Monitoring System (Model: GM01HAC) was assessed by comparing blood glucose results obtained by patients with those obtained using a YSI Model 2300 Glucose Analyzer, a laboratory instrument.

The following results were obtained by diabetic patients at clinic centers.

Slope	0.964
y-intercept	0.199 mmol/L
Correlation coefficient (r)	0.997
Number of tests	600
Range tested	2.6–29.2 mmol/L

System accuracy results for glucose concentration < 5.55 mmol/L

Within \pm 0.28 mmol/L	Within \pm 0.56 mmol/L	Within \pm 0.83 mmol/L
136/204 (66.7%)	197/204 (96.6%)	203/204 (99.5%)

System accuracy results for glucose concentration \geq 5.55 mmol/L

Within \pm 5%	Within \pm 10%	Within \pm 15%
264/396 (66.7%)	379/396 (95.7%)	395/396 (99.7%)

System accuracy results for glucose concentrations between 2.6 mmol/L and 29.2 mmol/L

Within \pm 0.83 mmol/L and Within \pm 15%
598/600 (99.7%)

Precision: The precision studies were performed in a laboratory using CareSens Dual Blood Glucose Monitoring Systems.

<i>Within Run Precision</i>		
Blood avg.	2.5 mmol/L	0.1 mmol/L
Blood avg.	4.3 mmol/L	0.2 mmol/L
Blood avg.	6.9 mmol/L	CV = 4.2%
Blood avg.	10.3 mmol/L	CV = 3.3%
Blood avg.	16.3 mmol/L	CV = 3.0%

<i>Between Run Precision</i>		
Control avg.	2.3 mmol/L	0.1 mmol/L
Control avg.	6.7 mmol/L	CV = 4.1%
Control avg.	17.3 mmol/L	CV = 3.1%

This study shows that there could be variation of up to 4.2%

Packed Cell Volume (Hematocrit)

The hematocrit levels (15–65%) were tested to evaluate the effect of hematocrit level on measurement of glucose concentration.

Range mmol/L	Average of difference (Hct 15–65%)
1.7 to 2.8	-0.2–0.1 mmol/L
5.3 to 8.0	-3.6–1.7 %
215.5 to 23.3	-8.9–6.2 %

Interferences

The effect of various interfering substances was evaluated in whole blood samples on glucose measurements.

NO	Interferent	Difference Averages	
		Interval 1 2.8–5.5 mmol/L	Interval 2 13.9–19.4 mmol/L
1	Ascorbic acid	-0.13 mmol/L	0.0 %
2	Bilirubin	0.06 mmol/L	1.3 %
3	EDTA	0.09 mmol/L	1.4 %
4	Fructose	0.10 mmol/L	-0.3 %
5	Galactose	-0.13 mmol/L	-0.2 %
6	Heparin	-0.04 mmol/L	-0.8 %
7	Maltose	-0.12 mmol/L	-1.4 %
8	Maltotriose	-0.02 mmol/L	-0.1 %
9	Maltotetraose	0.02 mmol/L	-0.7 %
10	Mannose	-0.06 mmol/L	3.5 %
11	Xylose	1.88 mmol/L	8.9 %
12	2-deoxyglucose	0.13 mmol/L	0.2 %
13	Acetaminophen	-0.05 mmol/L	2.7 %
14	Cholesterol	0.04 mmol/L	-0.3 %
15	Creatinine	0.01 mmol/L	-1.9 %
16	D,L-arabinose	0.08 mmol/L	3.1 %
17	Dopamine	0.02 mmol/L	-0.3 %
18	Gentisic acid	0.04 mmol/L	2.7 %
19	Glucosamine	-0.06 mmol/L	-2.7 %

NO	Interferent	Difference Averages	
		Interval 1 2.8–5.5 mmol/L	Interval 2 13.9–19.4 mmol/L
20	Glutathione (Red)	-0.05 mmol/L	-0.8 %
21	Hemoglobin	-0.31 mmol/L	-2.8 %
22	Ibuprofen	0.09 mmol/L	-0.9 %
23	Icodextrin	-0.15 mmol/L	-0.4 %
24	L-DOPA	-0.13 mmol/L	0.0 %
25	Methyl-DOPA	-0.05 mmol/L	-1.4 %
26	Sodium salicylate	0.05 mmol/L	3.7 %
27	Sucrose	-0.02 mmol/L	-1.1 %
28	Tolazamide	-0.02 mmol/L	0.5 %
29	Tolbutamide	0.10 mmol/L	3.5 %
30	Triglyceride	-0.03 mmol/L	0.5 %
31	Uric acid	-0.03 mmol/L	-0.6 %
32	PAM	-0.10 mmol/L	1.6 %

Compounds of xylose ≥ 0.54 mmol/L at glucose concentrations of 2.8–5.6 mmol/L may cause overestimation of blood glucose results.

User Performance Evaluation

A study evaluating glucose values from fingertip capillary blood samples obtained by 100 lay persons showed the following results: 99.1% within ± 0.83 mmol/L of the medical laboratory values at glucose concentrations below 5.55 mmol/L, and 100% within $\pm 15\%$ of the medical laboratory values at glucose concentrations at or above 5.55 mmol/L.

Warranty Information

β-Ketone

Accuracy: The accuracy of the CareSens Dual Blood Glucose/Blood β -Ketone System (Model: GM01HAC) was assessed by comparing blood β -ketone results obtained by patients with those obtained using a Randox Monaco, a laboratory instrument.

Slope	1.012
Y-intercept	-0.0223
Correlation coefficient (r)	0.996
Number of tests	100
Range tested	0.015–7.2 mmol/L

Precision: Precision studies were performed in a laboratory using the CareSens Dual Blood β -Ketone Monitoring Systems.

<i>Within Run Precision</i>		
Blood avg.	0.5 mmol/L	SD = 0.04 mmol/L
Blood avg.	1.4 mmol/L	SD = 0.05 mmol/L
Blood avg.	3.2 mmol/L	CV = 2.9%
Blood avg.	5.5 mmol/L	CV = 3.1%
Blood avg.	7.2 mmol/L	CV = 3.8%

<i>Between Run Precision</i>		
Control avg.	0.7 mmol/L	SD = 0.05 mmol/L
Control avg.	2.4 mmol/L	CV = 4.0%
Control avg.	4.7 mmol/L	CV = 4.4%

This study shows that there could be a variation of up to 4.4%.

Manufacturer's Warranty

i-SENS, Inc. warrants that the CareSens Dual Meter shall be free of defects in material and workmanship in normal use for a period of five (5) years. The meter must have been subjected to normal use. The warranty does not cover improper handling, tampering, use, or service of the meter. Any claim must be made within the warranty period.

i-SENS will, at its discretion, repair or replace a defective meter or meter part that is covered by this warranty. As a matter of warranty policy, i-SENS will not reimburse the consumer's purchase price.

Obtaining Warranty Service

To obtain warranty service, you must return the defective meter or meter part along with proof of purchase to your nearest i-SENS sales or customer service representative.

MEMO

MEMO

MEMO